



Citadines on Bourke Melbourne



Citadines on Bourke Melbourne is the ideal choice for conferencing in the Melbourne Central Business District. Along with the services and facilities you would expect in a hotel and the comfort of a serviced residence, Citadines on Bourke Melbourne offers a variety of meeting space configurations along with breakout spaces of an outdoor terrace and indoor lounge to meet your needs.

From the large Coromandel Place room, which accommodates up to 300 people, to our 5 breakout rooms, accommodating between 20 and 100 people, Citadines on Bourke Melbourne offers flexible conference facilities that suit your requirements.

Located within Citadines on Bourke Melbourne is Heirloom an east meets west Restaurant and Bar offering good produce and fine technique, guests can enjoy casual to fine dining experiences, Heirloom is also available to cater for onsite events.

Citadines on Bourke Melbourne is located close to Parliament House, 101 Collins Street and SX1 and SX2 buildings.

In time off, visitors can experience Melbourne's pulsating heartbeat with some retail therapy in the Bourke Street Mall, Melbourne Central and QV shopping precincts. Alternatively discover the magic of the Melbourne Cricket Ground (MCG) and Rod Laver Arena with Australian Football League (AFL), cricket, tennis, as well as world-class concerts. Then relax and take a culinary journey through Melbourne's unique dining experiences, all right on your doorstep.

Citadines on Bourke Melbourne is one of a vibrant collection of The Ascott Limited's serviced residences in over 60 cities in Asia Pacific, Europe and the Gulf region. A member of CapitaLand, it is the global leader in branded serviced residences, bringing you more than 25 years' experience in supporting travellers who work and live away from home.

Conference Reservations (61-3) 9039 8815 and Email conference.melbourne@citadines.com

Citadines on Bourke Melbourne

| | | Theatre | Classroom | U-Shape | Cabaret | Boardroom | Cocktail | Banquet |
|---------------------|------------|---------|-----------|---------|---------|-----------|----------|---------|
| Coromandel Place | (259SqM) | 300 | 120 | 60 | 175 | 60 | 350 | 150 |
| Hardware Lane | (91SqM) | 100 | 60 | 30 | 50 | 30 | 100 | 50 |
| Market Lane | (86.8SqM) | 85 | 50 | 25 | 45 | 25 | 90 | 50 |
| Southern Cross Lane | (78.4SqM) | 80 | 45 | 20 | 40 | 20 | 80 | 50 |
| Bank Place | (66.36SqM) | 40 | 18 | 15 | 20 | 15 | 40 | 30 |
| Bennetts Lane | (33.18SqM) | 20 | 10 | N/A | 10 | 8 | 20 | 10 |
| Hosier Lane | (33.18SqM) | 20 | 10 | N/A | 10 | 8 | 20 | 10 |

Note: Coromandel Place and Bank Place can both be divided into a number of breakout rooms.

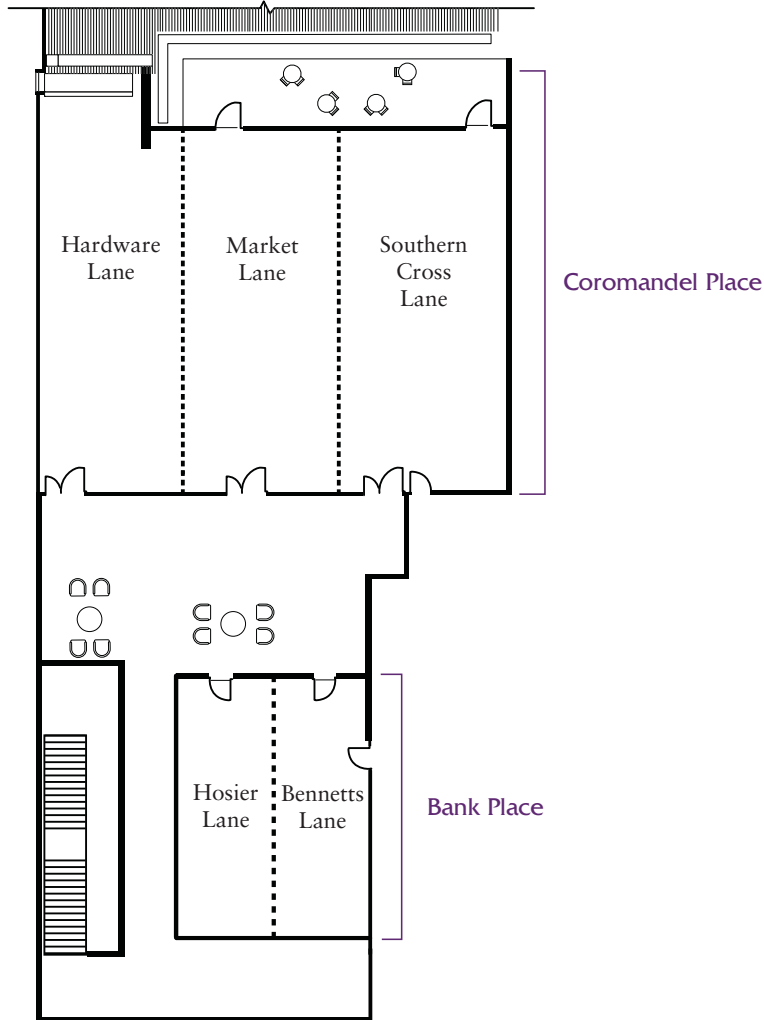

Services & Facilities - Conferencing

Services

- Audio visual equipment*
- Catering*
- WiFi access*

Facilities

- Adjustable conferencing areas
- Automatic projector screen
- Blackout blinds
- Multi adjustable lighting
- Natural light
- Outdoor Terrace Area
- Pre-function space
- Three-phase electricity

Services & Facilities - Accommodation

Services

- 24-hour reception
- Broadband internet access*
- Daily breakfast*
- Laundry and dry cleaning services*
- Meal delivery service*

Facilities

- Business Corner
- Carpark*
- Fitness Corner
- Indoor heated lap pool
- Restaurant and Bar*
- Sauna room

| Apartment Type | No. of Units |
|-----------------------|--------------|
| Studio Deluxe | 150 |
| Studio Executive | 129 |
| One-Bedroom Deluxe | 20 |
| One-Bedroom Executive | 40 |
| One-Bedroom Premier | 20 |
| Two-Bedroom Deluxe | 12 |
| Two-Bedroom Executive | 9 |

* Charges Apply

Citadines on Bourke Melbourne

131 - 135 Bourke Street
Melbourne, Victoria 3000
Australia

Telephone (61-3) 9039 8815

Facsimile (61-3) 9039 8899

Email conference.melbourne@citadines.com

Photos are a representation of the product.

